

勘测定界图

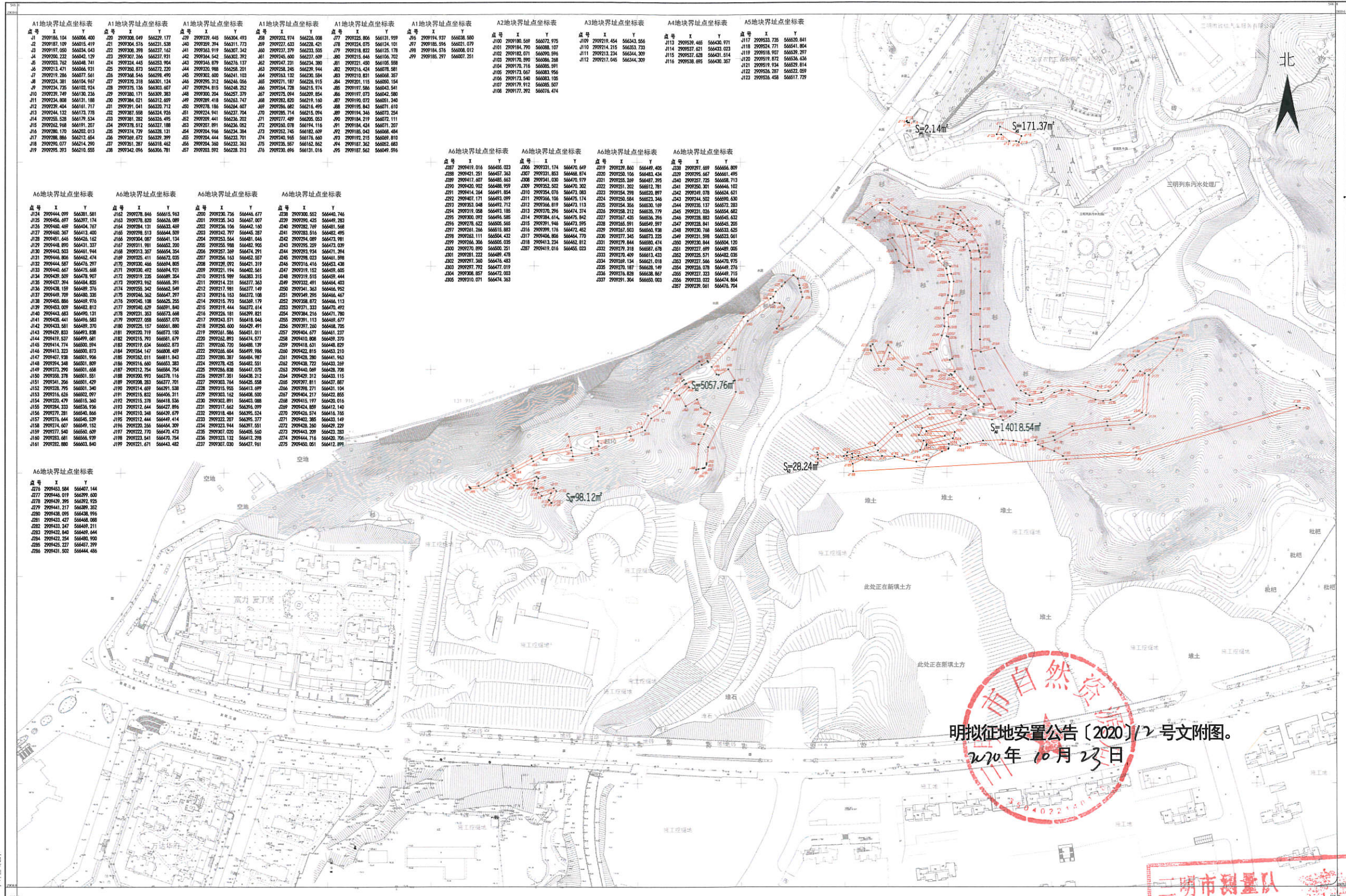

A1地块界址点坐标表		
点号	X	Y
J1	2909146.104	566006.420
J2	2909187.109	566015.419
J3	2909197.050	566034.043
J4	2909205.232	566050.122
J5	2909232.742	566048.741
J6	2909211.471	566056.921
J7	2909219.286	566077.569
J8	2909224.381	566104.957
J9	2909234.728	566102.924
J10	2909222.749	566112.226
J11	2909234.808	566131.188
J12	2909229.404	566141.717
J13	2909234.127	566172.728
J14	2909258.528	566179.534
J15	2909242.948	566191.267
J16	2909288.170	566202.019
J17	2909288.884	566212.654
J18	2909290.077	566214.290
J19	2909293.373	566210.033

A6地块界址点坐标表		
点号	X	Y
J124	2909444.099	566381.681
J125	2909456.677	566377.174
J126	2909462.469	566404.787
J127	2909460.387	566413.769
J128	2909465.645	566424.182
J129	2909448.890	566431.377
J130	2909443.533	566441.144
J131	2909448.806	566452.474
J132	2909444.857	566475.277
J133	2909440.687	566484.688
J134	2909439.509	566478.927
J135	2909437.394	566484.825
J136	2909438.189	566489.376
J137	2909449.709	566480.326
J138	2909456.886	566489.976
J139	2909453.009	566482.812
J140	2909443.643	566490.131
J141	2909438.441	566496.583
J142	2909435.581	566492.270
J143	2909429.833	566493.828
J144	2909419.537	566497.681
J145	2909414.774	566503.594
J146	2909413.323	566500.873
J147	2909417.928	566501.906
J148	2909394.340	566501.809
J149	2909373.290	566501.688
J150	2909358.378	566501.531
J151	2909341.286	566501.429
J152	2909328.795	566501.340
J153	2909316.628	566502.097
J154	2909303.479	566503.280
J155	2909284.333	566504.936
J156	2909277.281	566503.866
J157	2909273.644	566505.539
J158	2909274.607	566505.132
J159	2909277.540	566506.609
J160	2909283.681	566506.939
J161	2909282.880	566506.540

A6地块界址点坐标表		
点号	X	Y
J276	2909483.584	566407.144
J277	2909446.019	566399.600
J278	2909439.296	566392.728
J279	2909441.217	566389.382
J280	2909438.095	566408.976
J281	2909433.427	566408.088
J282	2909433.247	566409.211
J283	2909432.840	566409.444
J284	2909432.254	566409.900
J285	2909425.227	566407.399
J286	2909431.502	566444.486

A2地块界址点坐标表		
点号	X	Y
J100	2909180.569	566072.975
J101	2909184.790	566088.107
J102	2909182.071	566090.596
J103	2909170.390	566096.268
J104	2909170.716	566098.091
J105	2909173.067	566093.156
J106	2909173.940	566093.108
J107	2909170.912	566092.507
J108	2909177.392	566074.474

A6地块界址点坐标表		
点号	X	Y
J287	2909419.816	566458.023
J288	2909421.251	566457.363
J289	2909417.087	566455.063
J290	2909420.922	566458.959
J291	2909414.264	566451.884
J292	2909407.171	566453.099
J293	2909353.048	566492.712
J294	2909319.058	566493.185
J295	2909300.092	566494.585
J296	2909318.422	566502.565
J297	2909316.264	566515.883
J298	2909323.111	566504.422
J299	2909326.366	566505.025
J300	2909370.890	566500.251
J301	2909381.222	566489.478
J302	2909387.290	566476.483
J303	2909397.792	566477.013
J304	2909398.087	566472.503
J305	2909310.071	566474.363

三明市自然资源局
明以征地安置公告〔2020〕12号文附图。
2020年10月23日

三明市测量队
测绘资质：乙级
证书编号：乙测资字 3510615
发证机关：福建省测绘地理信息局

1:XXX国家大地坐标系, 中央经度117°E
1:XXX国家高程基准, 黄海高程系
2:1地形图
2019年12月数据