

三明市瑞云智慧新城市政路网工程—陈大路项目勘测定界图

界址点坐标表

点号	X	Y	点号	X	Y	点号	X	Y
J1	2912672.764	39565492.303	J79	2912124.862	39565422.848	J158	2912063.907	39565404.461
J2	2912673.494	39565495.113	J80	2912148.743	39565435.005	J159	2911831.941	39565146.807
J3	2912644.671	39565504.037	J81	2912176.252	39565444.170	J160	2911825.612	39565139.710
J4	2912639.932	39565504.852	J82	2912202.887	39565448.790	J161	2911819.350	39565132.555
J5	2912631.118	39565505.324	J83	2912232.734	39565449.374	J162	2911781.913	39565092.449
J6	2912622.197	39565505.950	J84	2912252.957	39565447.044	J163	2911767.020	39565072.777
J7	2912616.992	39565505.338	J85	2912269.330	39565445.262	J164	2911745.696	39565043.889
J8	2912614.289	39565505.020	J86	2912301.420	39565442.655	J165	2911749.769	39565041.635
J9	2912606.788	39565503.642	J87	2912324.597	39565443.227	J166	2911705.198	39564999.502
J10	2912602.656	39565501.429	J88	2912349.176	39565446.096	J167	2911691.798	39564941.035
J11	2912597.355	39565497.375	J89	2912363.171	39565448.796	J168	2911707.751	39564946.178
J12	2912597.249	39565497.301	J90	2912527.936	39565485.265	J169	2911711.901	39564951.800
J13	2912592.010	39565493.967	J91	2912560.536	39565491.159	J170	2911705.779	39564964.995
J14	2912591.660	39565493.803	J92	2912554.370	39565491.837	J171	2911730.716	39564977.290
J15	2912584.675	39565491.581	J93	2912554.273	39565491.851	J172	2911731.937	39564978.944
J16	2912584.481	39565491.533	J94	2912554.078	39565491.899	J173	2911736.089	39564994.695
J17	2912584.345	39565491.516	J95	2912536.140	39565497.614	J174	2911746.205	39564998.273
J18	2912580.962	39565491.234	J96	2912536.091	39565497.630	J175	2911789.145	39565056.446
J19	2912584.546	39565490.960	J97	2912533.716	39565498.477	J176	2911799.264	39565069.912
J20	2912635.938	39565493.767	J98	2912527.955	39565500.530	J177	2911823.391	39565096.086
J21	2912666.933	39565492.923	J99	2912525.283	39565501.483	J178	2911825.519	39565104.045
J22	2912673.581	39565495.448	J100	2912517.856	39565504.130	J179	2911831.522	39565118.162
J23	2912680.735	39565522.999	J101	2912518.885	39565506.949	J180	2911809.281	39565091.506
J24	2912645.392	39565524.715	J102	2912523.646	39565505.251	J181	2911807.249	39565089.070
J25	2912620.462	39565520.990	J103	2912531.772	39565502.355	J182	2911784.046	39565061.261
J26	2912597.559	39565519.752	J104	2912533.599	39565501.703	J183	2911760.842	39565033.452
J27	2912571.269	39565517.104	J105	2912536.029	39565500.837	J184	2911760.267	39565032.745
J28	2912554.428	39565514.709	J106	2912535.827	39565499.856	J185	2911738.004	39565005.382
J29	2912538.822	39565515.050	J107	2912543.596	39565496.810	J186	2911729.070	39564994.402
J30	2912522.101	39565511.627	J108	2912544.808	39565493.566	J187	2911702.374	39564961.837
J31	2912508.026	39565508.512	J109	2912560.136	39565492.605	J188	2911697.877	39564967.913
J32	2912494.029	39565502.341	J110	2912565.218	39565492.110	J189	2911693.809	39564962.155
J33	2912357.984	39565472.229	J111	2912565.762	39565492.104	J190	2911691.808	39564964.992
J34	2912334.545	39565468.257	J112	2912566.888	39565492.308	J191	2911655.264	39564915.485
J35	2912311.236	39565466.651	J113	2912570.156	39565492.058	J192	2911670.953	39564903.904
J36	2912285.469	39565467.541	J114	2912570.479	39565492.055	J193	2911674.672	39564901.365
J37	2912266.655	39565469.973	J115	2912578.287	39565492.558	J194	2911675.096	39564901.300
J38	2912256.999	39565471.615	J116	2912582.265	39565493.085	J195	2911685.538	39564915.914
J39	2912231.205	39565474.390	J117	2912585.501	39565493.919	J196	2911692.211	39564914.092
J40	2912205.676	39565474.026	J118	2912590.192	39565496.129	J197	2911697.440	39564897.887
J41	2912176.905	39565469.879	J119	2912602.994	39565504.518	J198	2911699.252	39564897.610
J42	2912162.475	39565466.051	J120	2912607.739	39565506.571	J199	2911717.612	39564959.538
J43	2912151.061	39565460.200	J121	2912611.771	39565507.546	J200	2911720.008	39564962.784
J44	2912150.067	39565459.604	J122	2912619.321	39565508.125	J201	2911716.799	39564961.295
J45	2912126.203	39565447.934	J123	2912626.551	39565507.858			
J46	2912121.840	39565445.089	J124	2912637.581	39565506.596			
J47	2912119.568	39565443.084	J125	2912648.467	39565504.548			
J48	2912115.077	39565439.122	J126	2912654.421	39565502.937			
J49	2912109.108	39565432.535	J127	2912660.403	39565500.846			
J50	2912096.871	39565419.032	J128	2911709.311	39564984.377			
J51	2912088.546	39565409.347	J129	2911723.798	39565002.182			
J52	2912064.524	39565381.400	J130	2911748.690	39565032.776			
J53	2912064.454	39565381.320	J131	2911750.176	39565031.755			
J54	2912038.326	39565352.335	J132	2911783.079	39565070.336			
J55	2912012.197	39565323.351	J133	2911786.828	39565074.732			
J56	2911973.284	39565278.717	J134	2911797.902	39565088.095			
J57	2911934.372	39565234.084	J135	2911806.216	39565098.126			
J58	2911918.261	39565216.162	J136	2911840.798	39565138.425			
J59	2911909.000	39565205.860	J137	2911861.637	39565161.397			
J60	2911898.293	39565193.950	J138	2911893.383	39565196.392			
J61	2911872.758	39565165.544	J139	2911901.485	39565205.323			
J62	2911855.304	39565146.128	J140	2911914.264	39565219.410			
J63	2911849.076	39565139.201	J141	2911940.155	39565248.468			
J64	2911847.131	39565136.869	J142	2911961.604	39565271.786			
J65	2911844.491	39565133.706	J143	2911971.482	39565283.669			
J66	2911839.122	39565127.271	J144	2911973.720	39565286.226			
J67	2911847.943	39565123.346	J145	2911982.266	39565295.986			
J68	2911852.378	39565128.407	J146	2911987.947	39565303.095			
J69	2911892.069	39565172.493	J147	2911993.632	39565310.209			
J70	2911912.907	39565200.869	J148	2911996.027	39565312.984			
J71	2911945.686	39565237.278	J149	2912016.554	39565336.779			
J72	2911986.058	39565282.121	J150	2912066.608	39565394.801			
J73	2911998.324	39565291.262	J151	2912083.111	39565413.242			
J74	2912018.993	39565314.220	J152	2912083.075	39565413.272			
J75	2912026.800	39565327.375	J153	2912105.829	39565440.062			
J76	2912075.230	39565378.947	J154	2912106.390	39565446.645			
J77	2912082.305	39565387.682	J155	2912090.241	39565429.123			
J78	2912102.779	39565407.254	J156	2912078.126	39565418.816			
J79	2912124.862	39565422.848	J157	2912071.017	39565411.638			

北

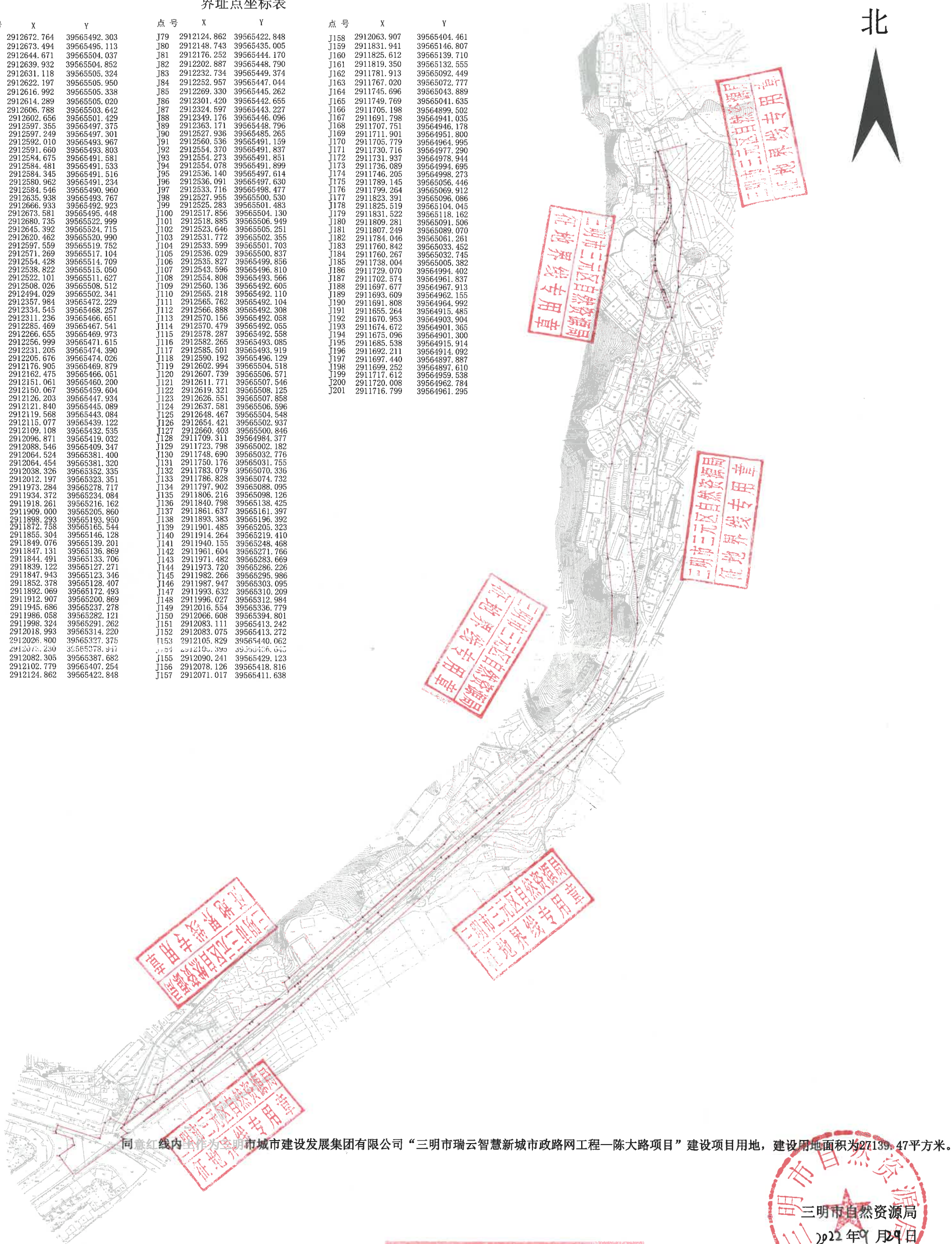

同意红线内土地作为三明市城市建设发展集团有限公司“三明市瑞云智慧新城市政路网工程—陈大路项目”建设项目用地，建设用地面积为27139.47平方米。



三明市测量队
测绘资质：甲级
证书编号：甲测资字35100005
发证机关：福建省自然资源厅
35040410003620

测量员：张祥宝 林小强
绘图员：张祥宝
检查员：曹俊彦

三明市测量队

三明市测量队于2022年2月测制成图。
2000国家大地坐标系，中央子午线117° 00'。
1985国家高程基准，等高距1.0米。
2017图式